



DUMP-EZY

Dump Station

FENV906.0000

REGISTERED DESIGN 202116495

Installation & Usage Instructions

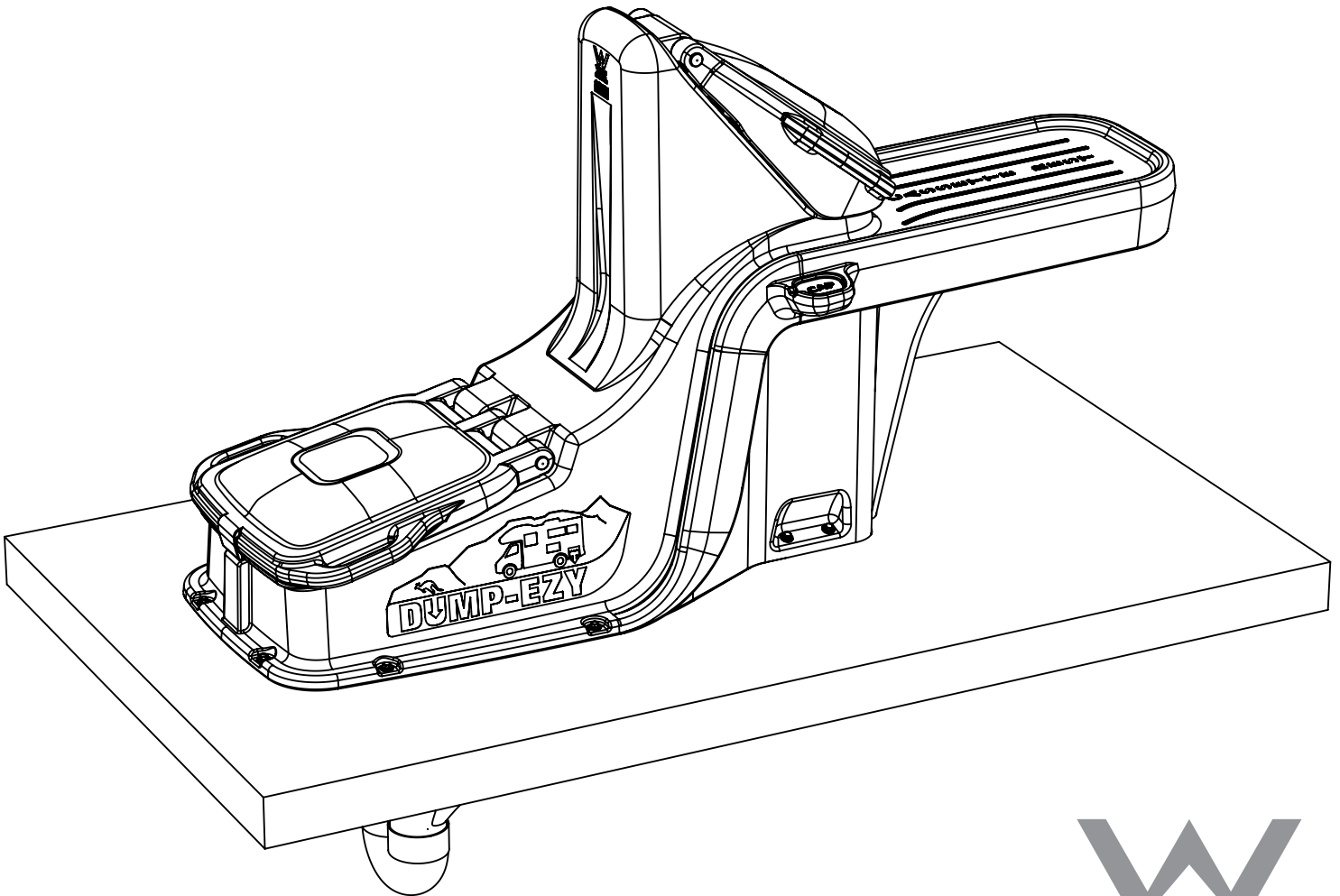

WaterMark

WMTS - 482

Lic WMKT 21102

GOUGH
PLASTICS

Standard Inclusions

Rubber O-Ring Seal
supplied with Dump Station

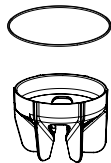

***150mm Rubbish Block**
supplied with Dump Station

*Fit down inside the
150mm L.I.T

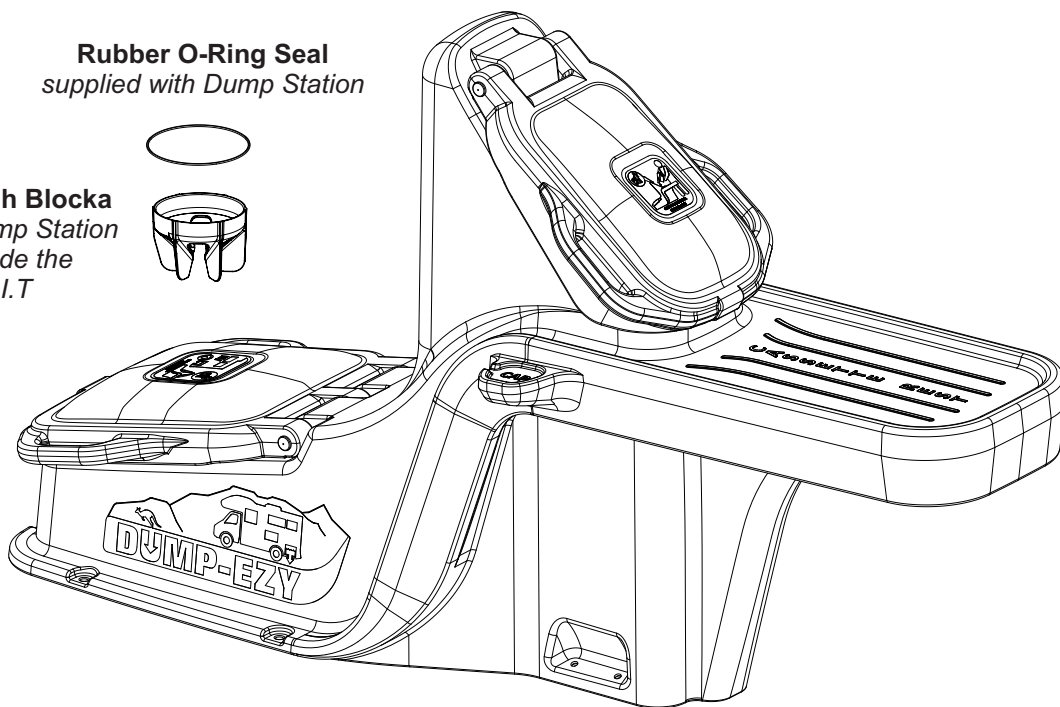

Required for installation: (Not Supplied)

- 100mm PVC-U DWV Pipe** - Qty 2m min.
- Stainless Fasteners** - 10mm x 75 Hex Nut Dynabolts e.g Ramset™ #DP10075S - Qty 6
- 10mm x 100 Hex Nut Dynabolts e.g Ramset™ #DP10075S - Qty 4
- M10 SS Round Flat Washers (24mm approx dia.) - Qty 10
- Caulking Sealant** - e.g Sikaflex PRO™ - Grey
- PVC Pipe Cement**
- Sewer Plumbing Kit** - (Can be purchased from Dump Station Supplier, as per below)

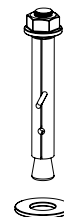

Sewer Plumbing Kit (Can be purchased from Dump Station supplier)



150mm
Access Coupling

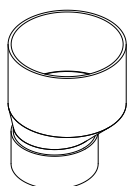

150mm
Level Invert Taper

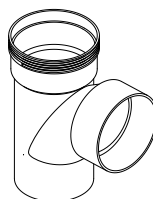

100mm x 88°
Junction M-F

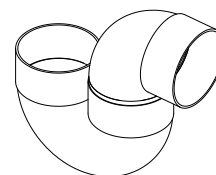

100mm
Dis-connector Trap

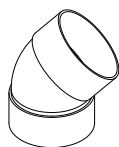

100mm x 45°
Bend F-F

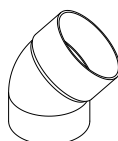

100mm x 43°
Bend M-E



100mm Inline
Pan Collar

Installation Guidelines

Installation

All installations should comply with AS/NZS 3500.2 Section 3.15

Site Location

When selecting a site to install the Dump-ezy consideration should be given to traffic in and around the area. Consideration should be given to any nearby features such as toilet blocks, tables, play grounds etc. Side access roads / isolated pull over bays are ideal.

Barriers

Physical barriers such as concrete kerbing, metal railings, treated pine stumps etc can help prevent vehicles and similar from coming in contact with the Dump-ezy. These should be positioned in a way that still allows clear access for persons and hoses / cartridges.

Signage

Adequate signage should also be installed to make people visibly aware of the Dump-ezy. Talk to your sales representative.

Hose Wash Down

A tap and hose should be provided next to installations to enable wash down with each use.

This ensures a nice clean unit is maintained.

Note: If a back-flow prevention device is installed on the hose cock it will require inspection and certification under AS 3500.

Drainage

Adequate drainage should be provided in and around the Dump-ezy to prevent infiltration from high rainfall, runoff etc.

Pipework and Fittings

Pipework and fittings should be checked as per standard plumbing guidelines.

Fittings should be inspected for leaks at joints and tank connections.

Important ⚠️ Install the Dump Station lower than vehicle outlet height shown so waste can drain through hose via gravity.

⚠️ For compliance with Plumbing Standard AS/NZS 3500.2 the minimum height of the front edge of the low basin must be at least 150mm above ground level. (This is to prevent inflow of ground water into the sewer)

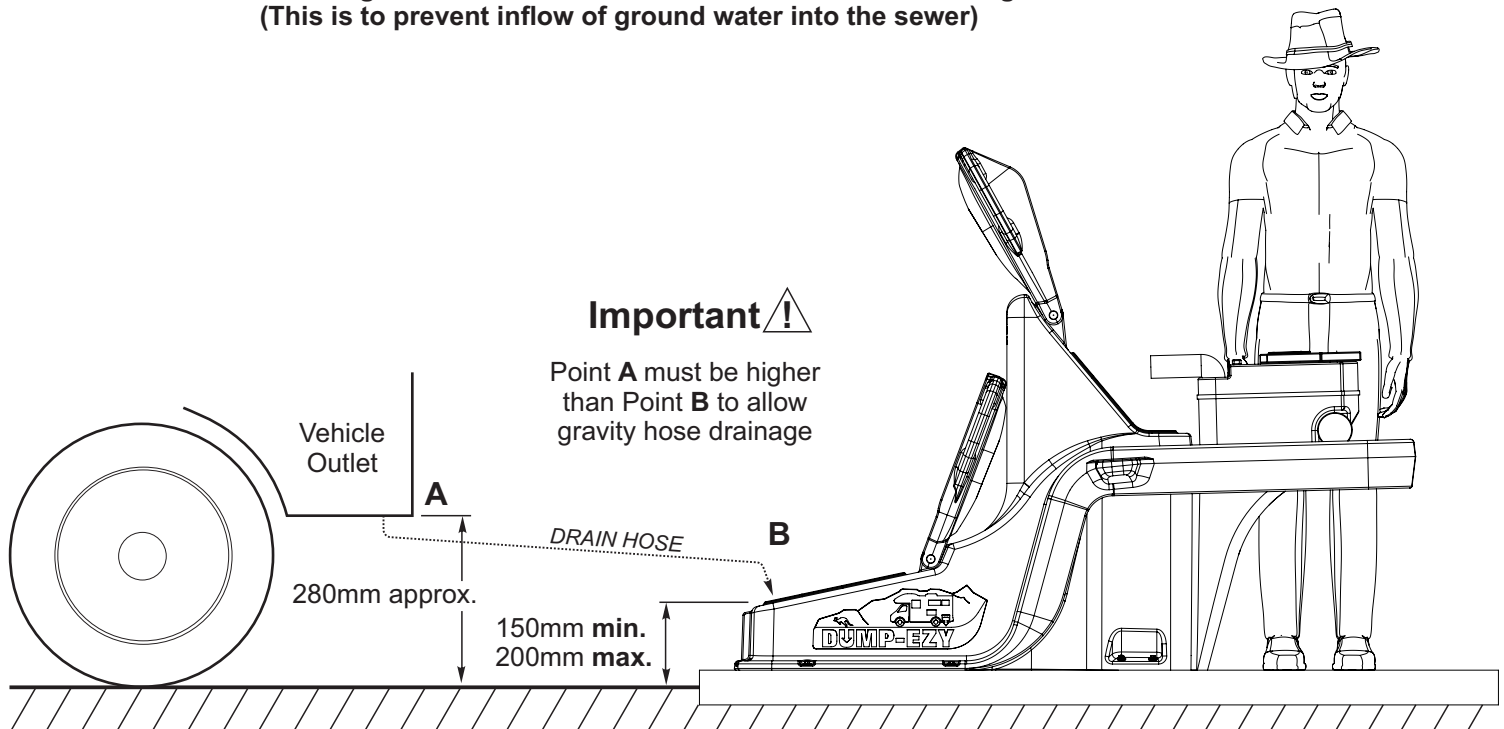

Site Location (Guide Only)

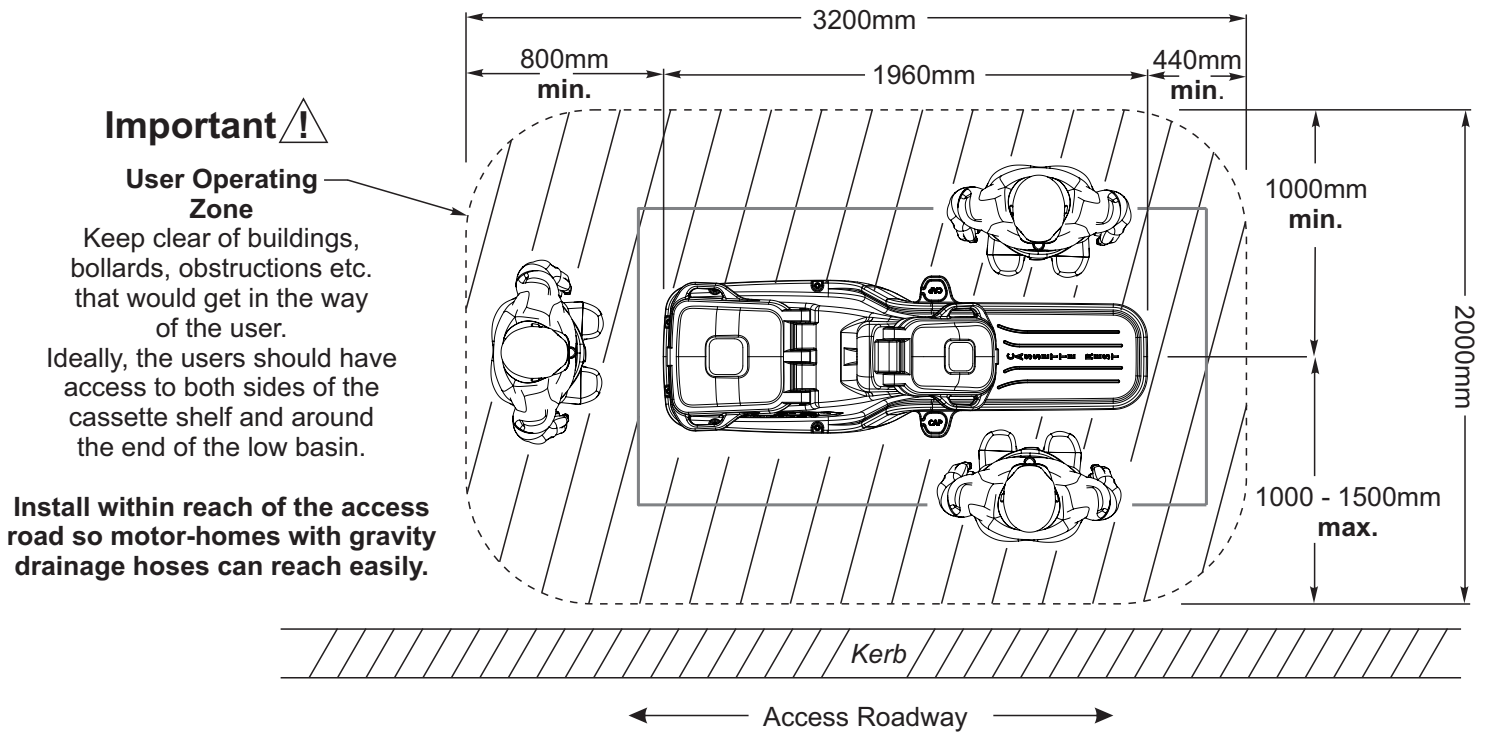

e.g Parallel to Roadway

e.g Perpendicular to Roadway

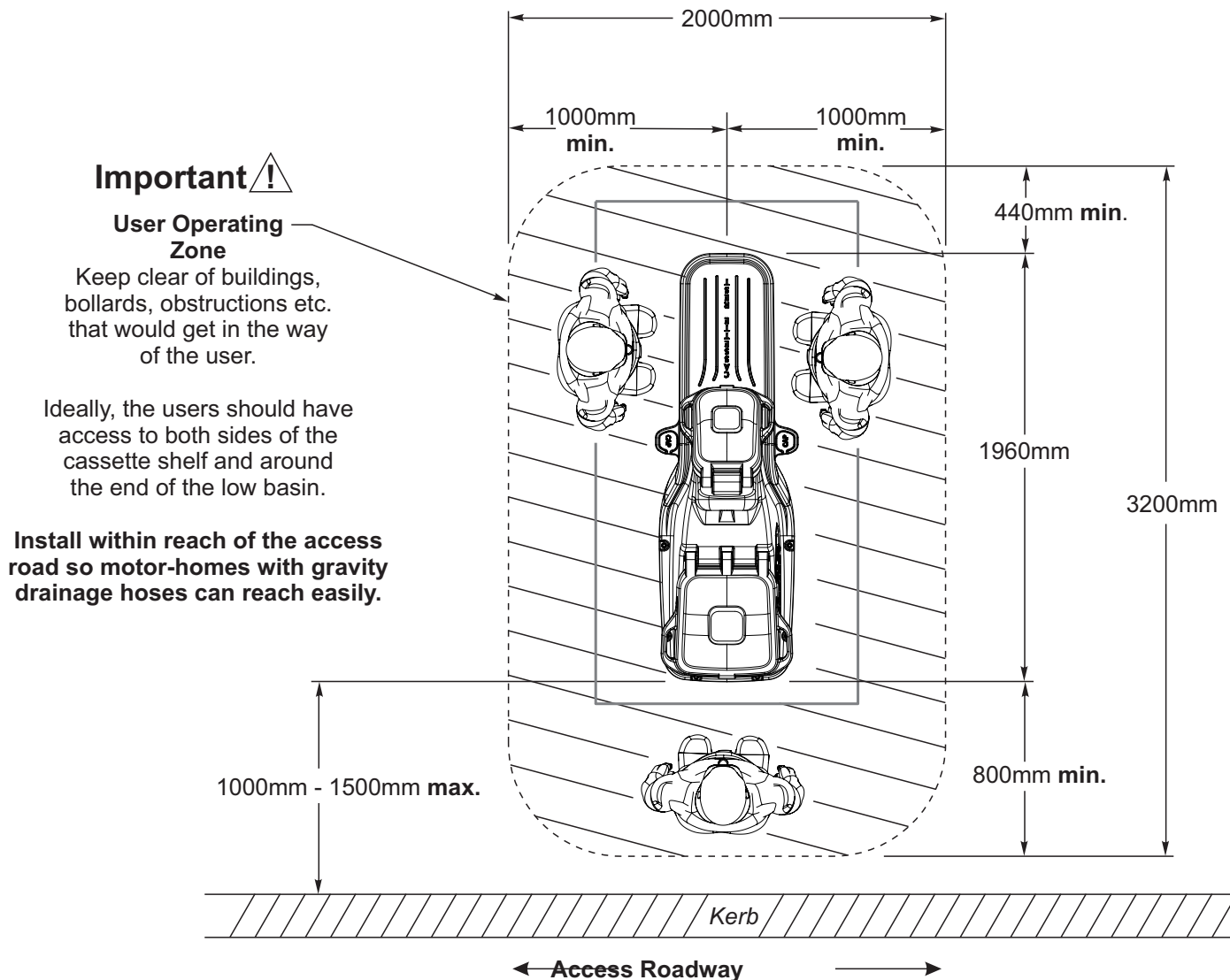

Plumbing & Concrete Slab Set-up - Option A

Single trap

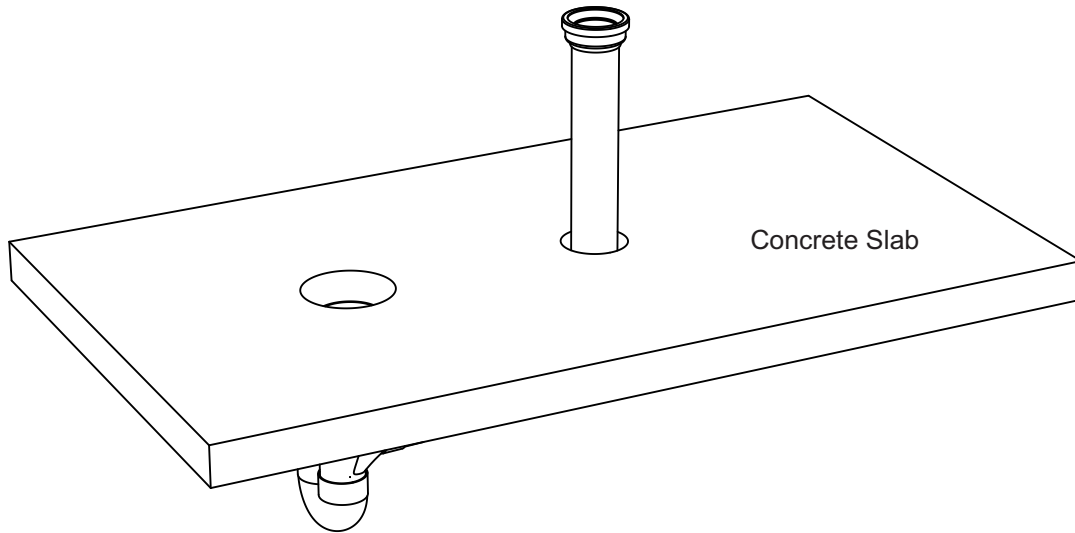

Important

All Plumbing & Installation shall be in accordance with AS/NZS 3500.2 Sanitary Plumbing and Drainage Standard

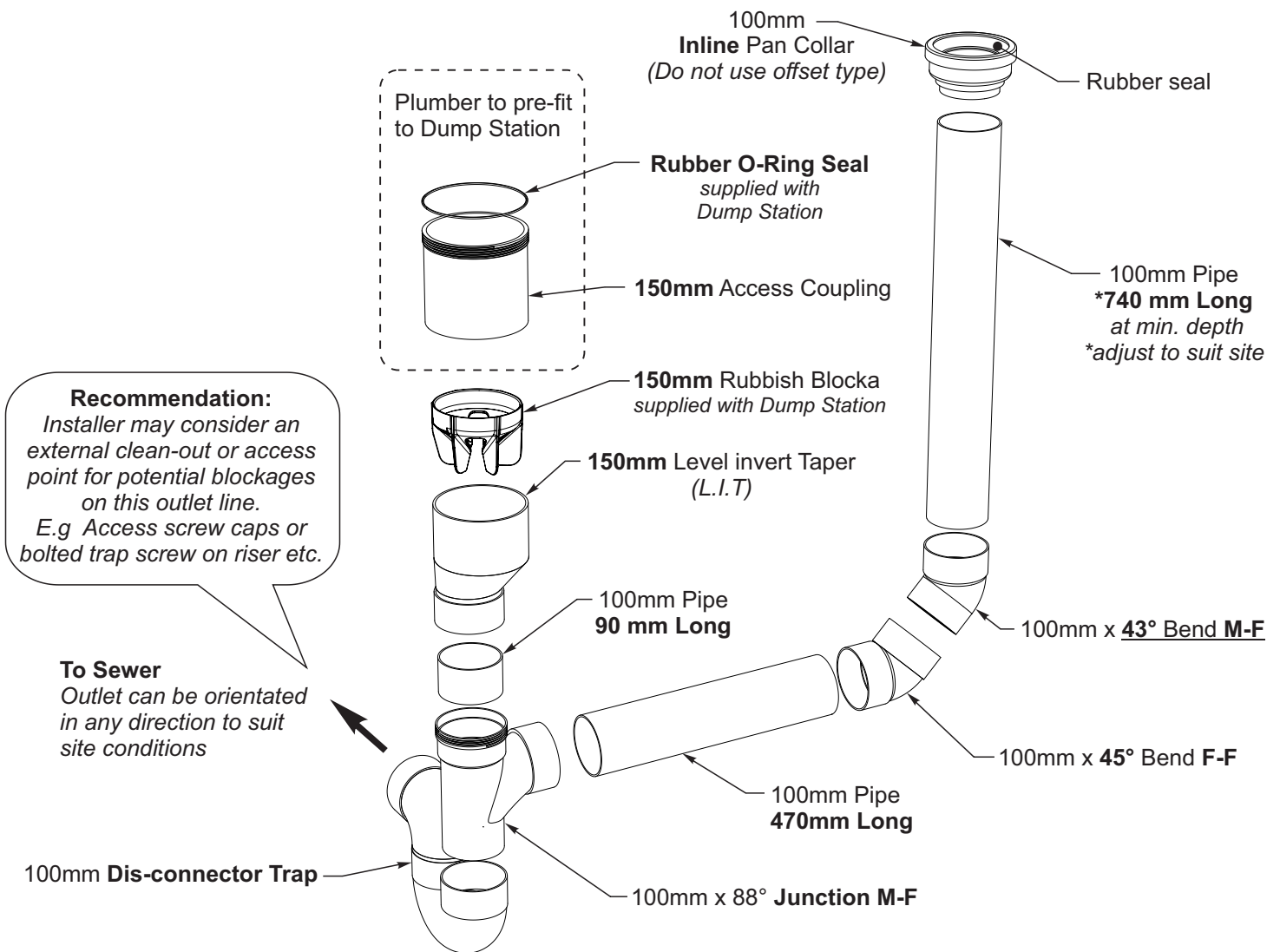

All Plumbing shall be 100mm DWV PVC-U unless noted otherwise

Plumbing & Concrete Slab Set-up - Single trap (depth permitting)

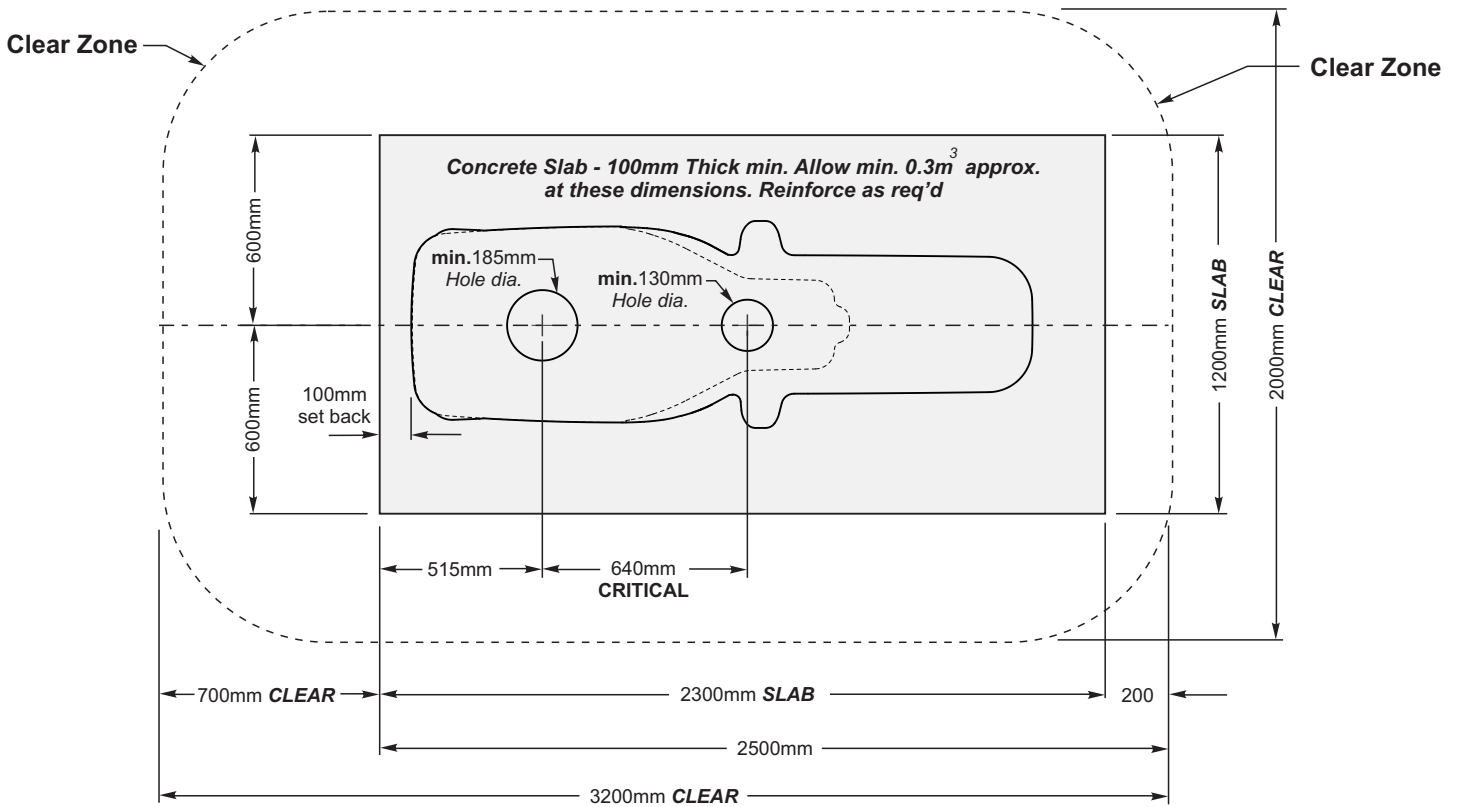

Top View

Very Important !

Form an oversized hole in the concrete around the Lever Invert Taper leaving clearance for the 150mm coupling to fit down the outside when the Dump Station is lowered into position. E.g wrap foam tape or a larger pipe offcut etc to form gap from concrete.

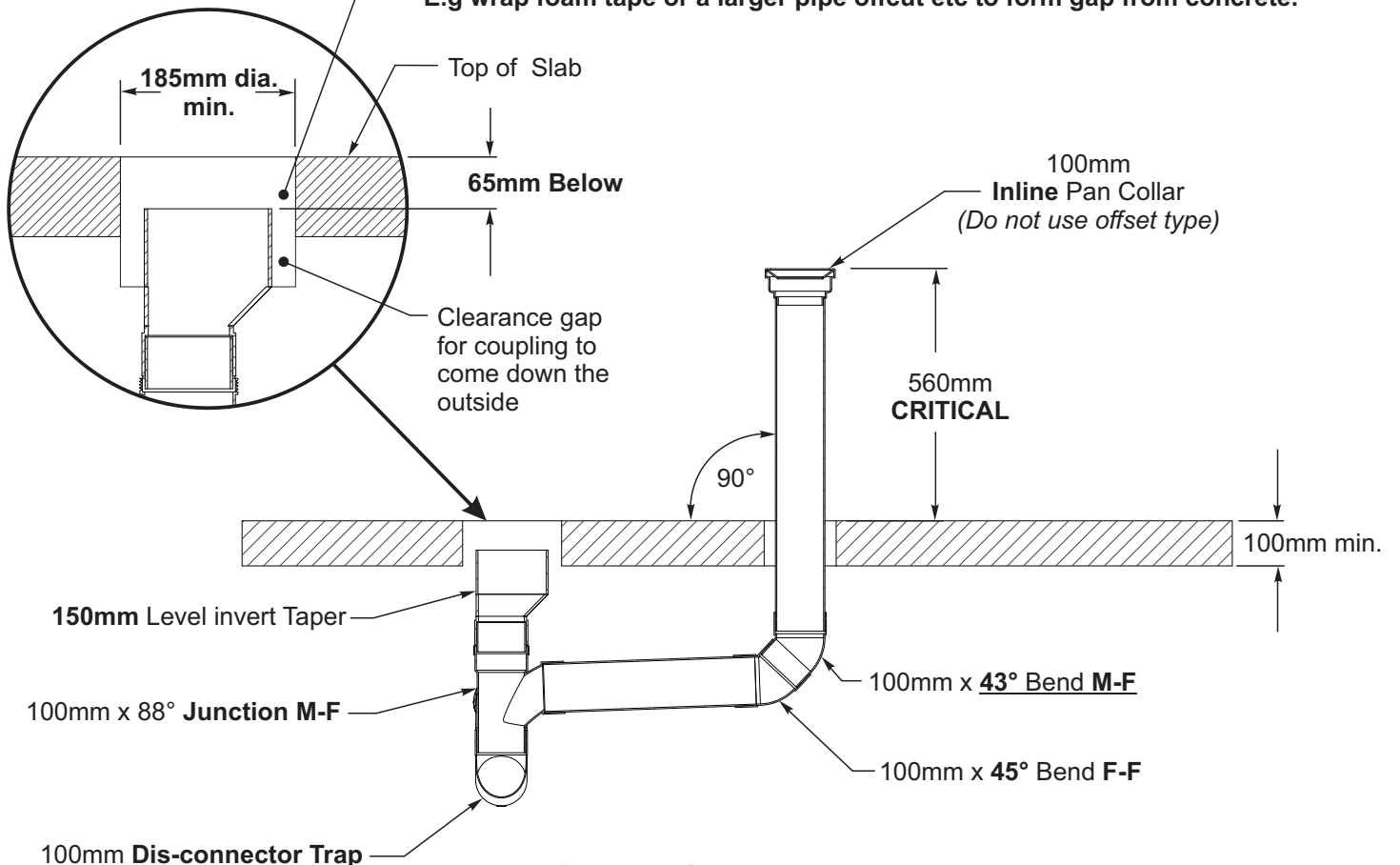

Cross Section

Plumbing & Concrete Slab Set-up - Option B

Double trap

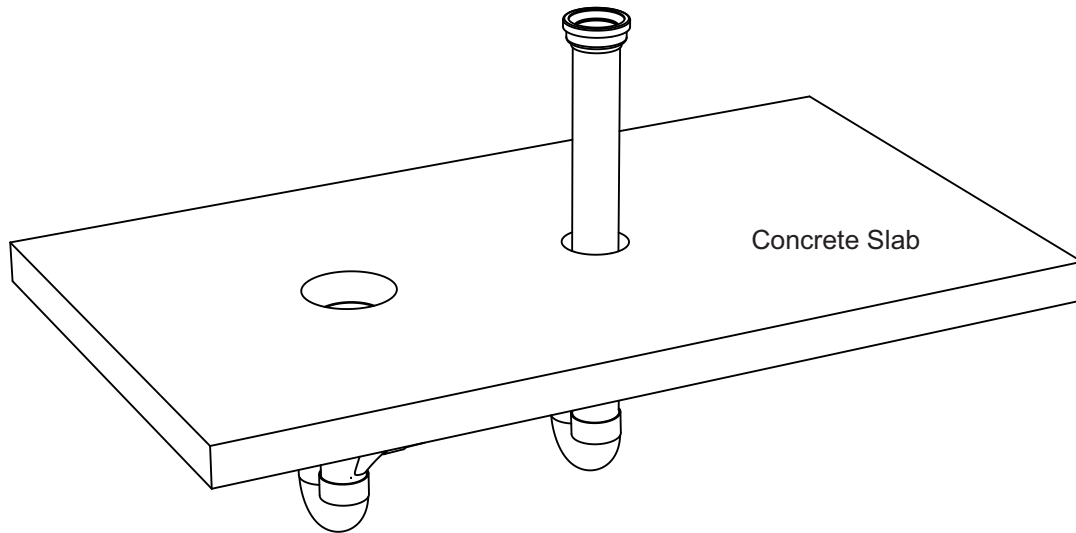

Important 

All Plumbing & Installation shall be in accordance with AS/NZS 3500.2 Sanitary Plumbing and Drainage Standard

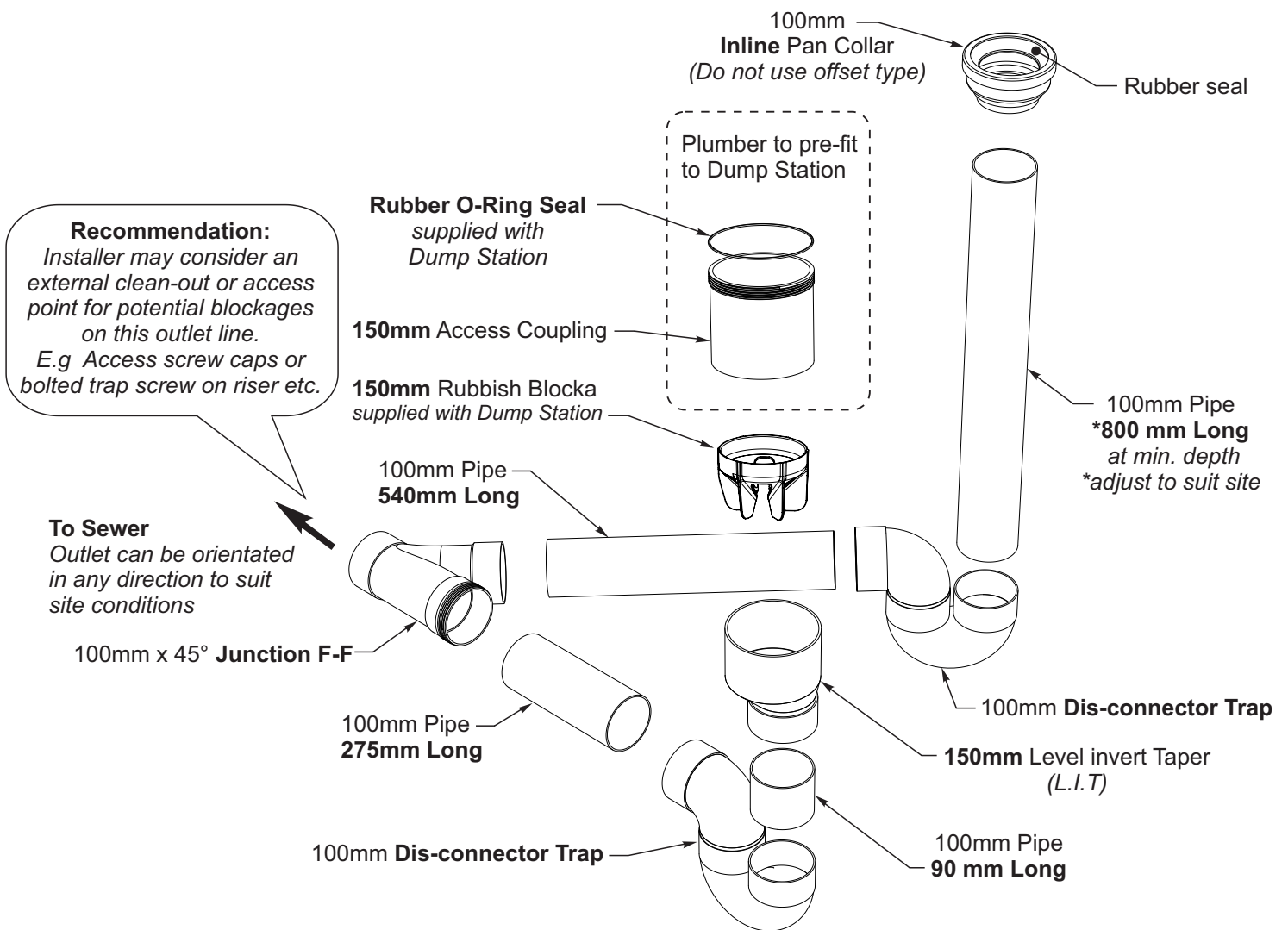

All Plumbing shall be 100mm DWV PVC-U unless noted otherwise

Plumbing & Concrete Slab Set-up - Double trap (shallow depth)

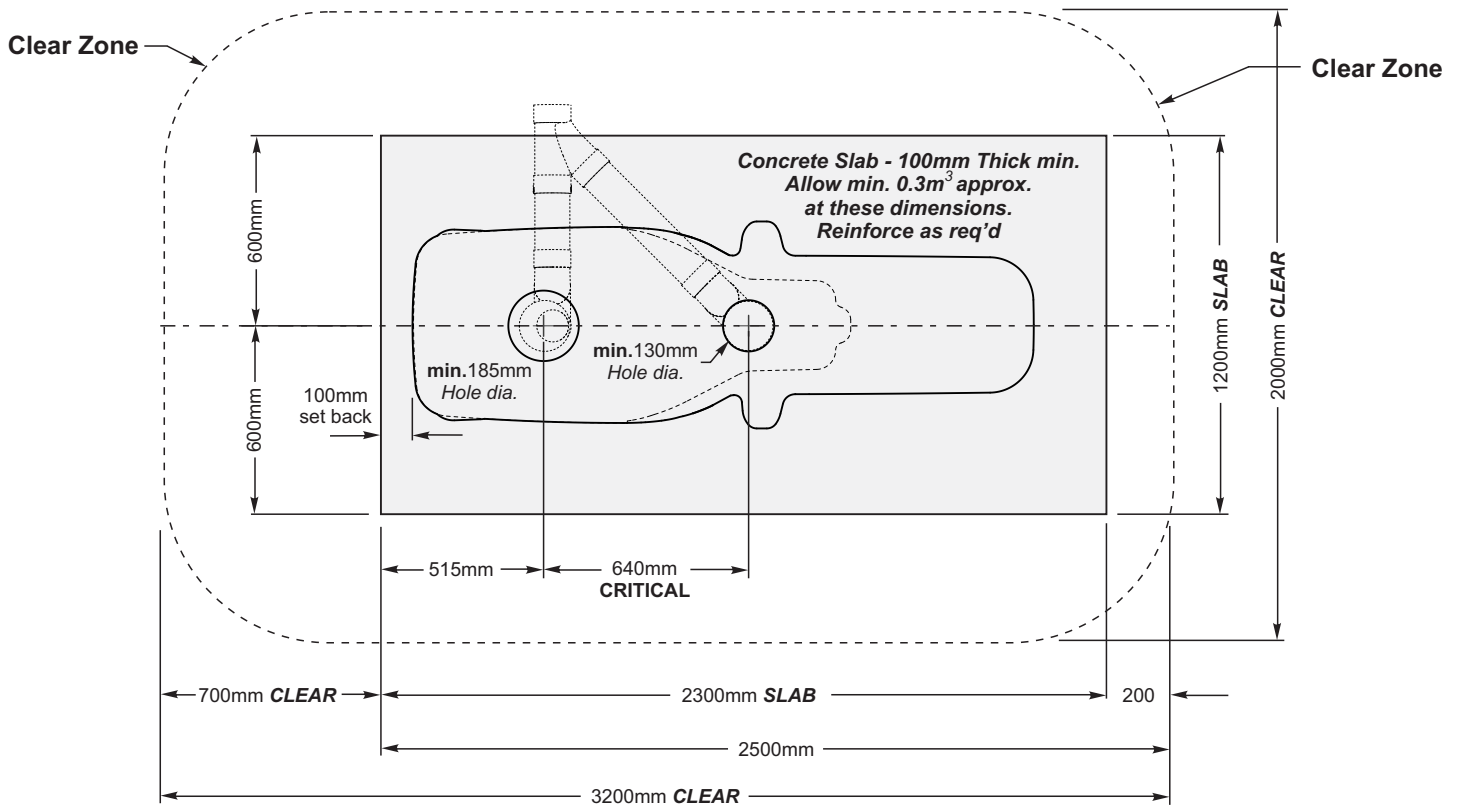

Top View

Very Important ⚠

Form an oversized hole in the concrete around the Lever Invert Taper leaving clearance for the 150mm coupling to fit down the outside when the Dump Station is lowered into position.
E.g wrap foam tape or a larger pipe offcut etc to form gap from concrete.

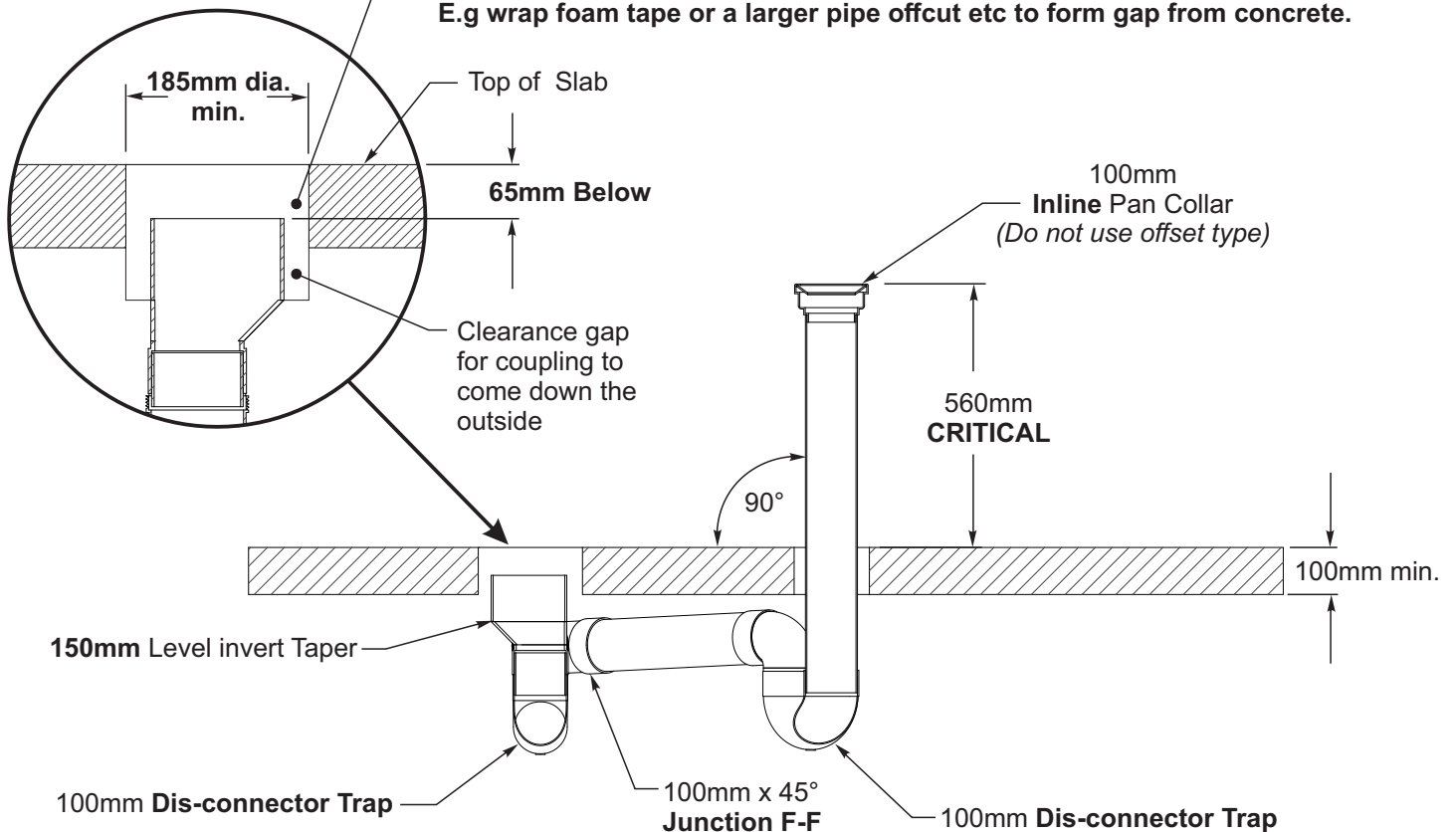

Cross Section

Pre-fitting the O-Ring & Coupling

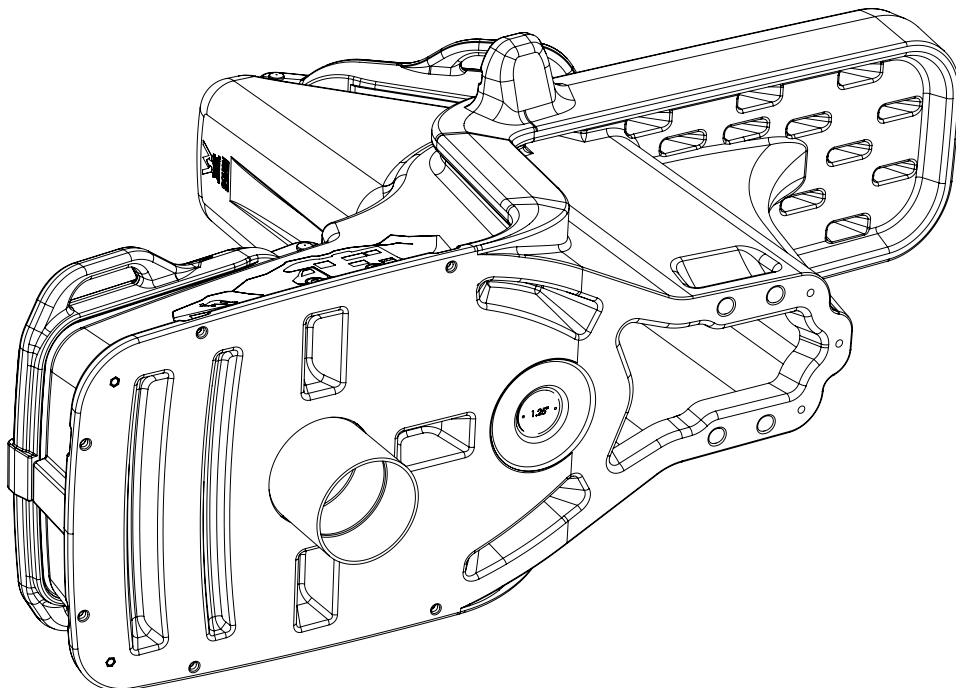
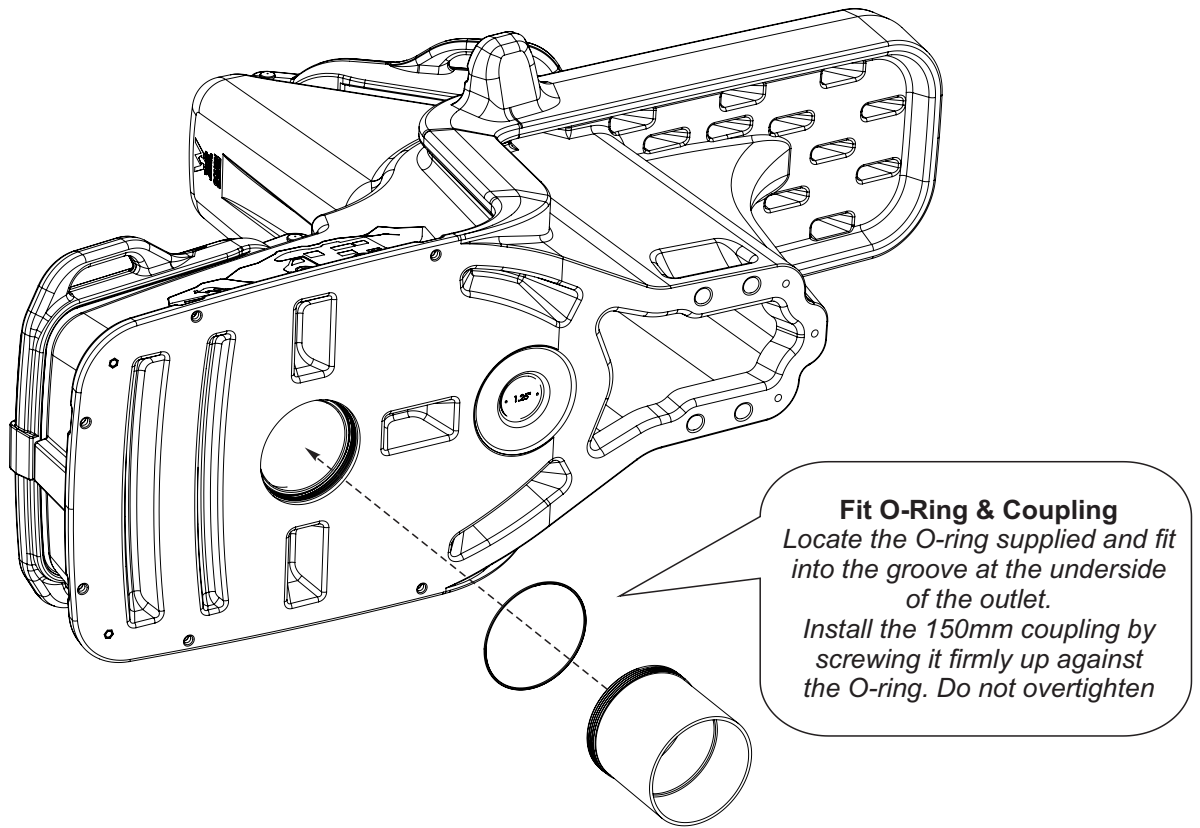

**O-Ring & Coupling fitted ready
for installation**

Installing the Dump Station

Place a large bead of elastic joint sealant (caulking material) just inside the perimeter of the Dump Station Base e.g. Sikaflex PRO™ - Grey

Carefully lower the Dump Station over the riser pipe. 2 Person lift recommended.

Carefully engage the high funnel spigot into the rubber pan collar and the low 150 coupling with the 150 L.I.T

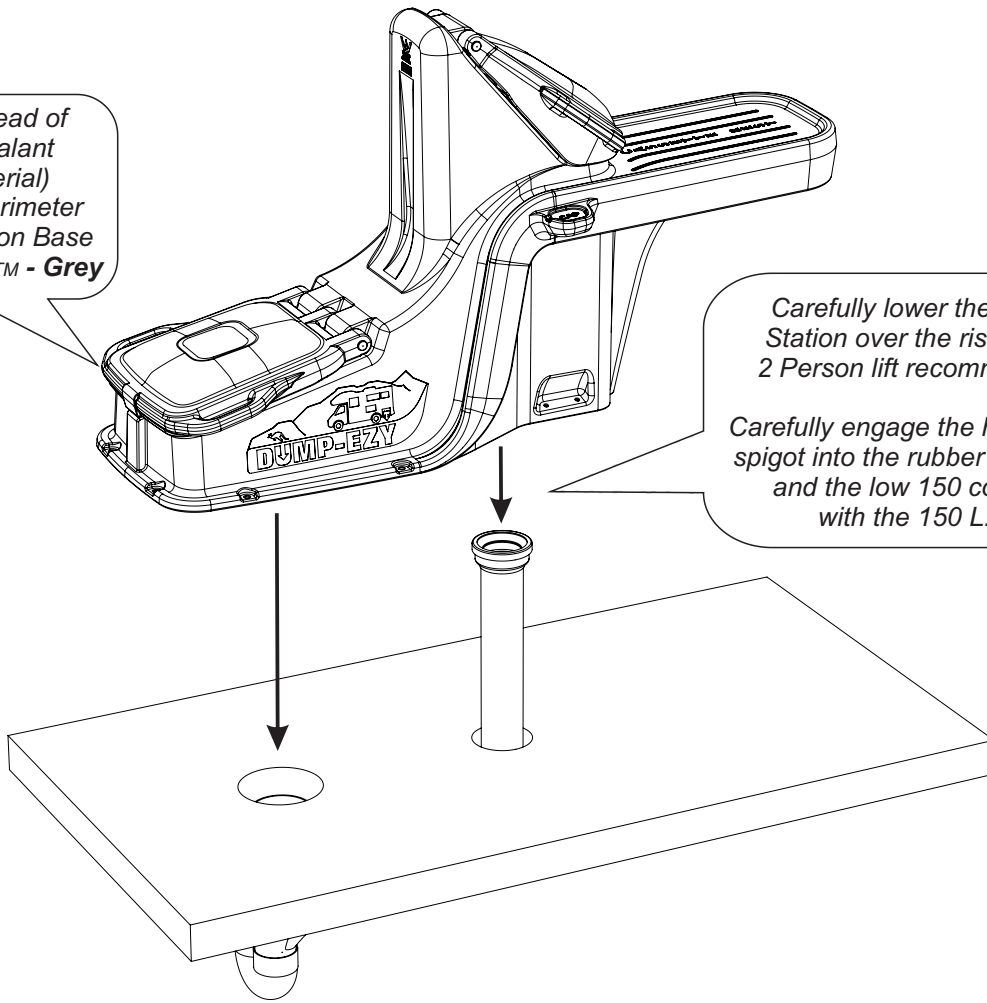

Insert the 150mm Rubbish Block down the hole to rest in the L.I.T

High Funnel Spigot engaged in Pan Collar rubber seal

Grey Caulking material underneath base flange perimeter to seal any gaps.

150mm Coupling engaged down the outside of the L.I.T Use PVC Pipe Cement

Indicative Plumbing shown
Plumbing method may vary to suit site conditions
Refer Single Trap & Double Trap examples in this document.

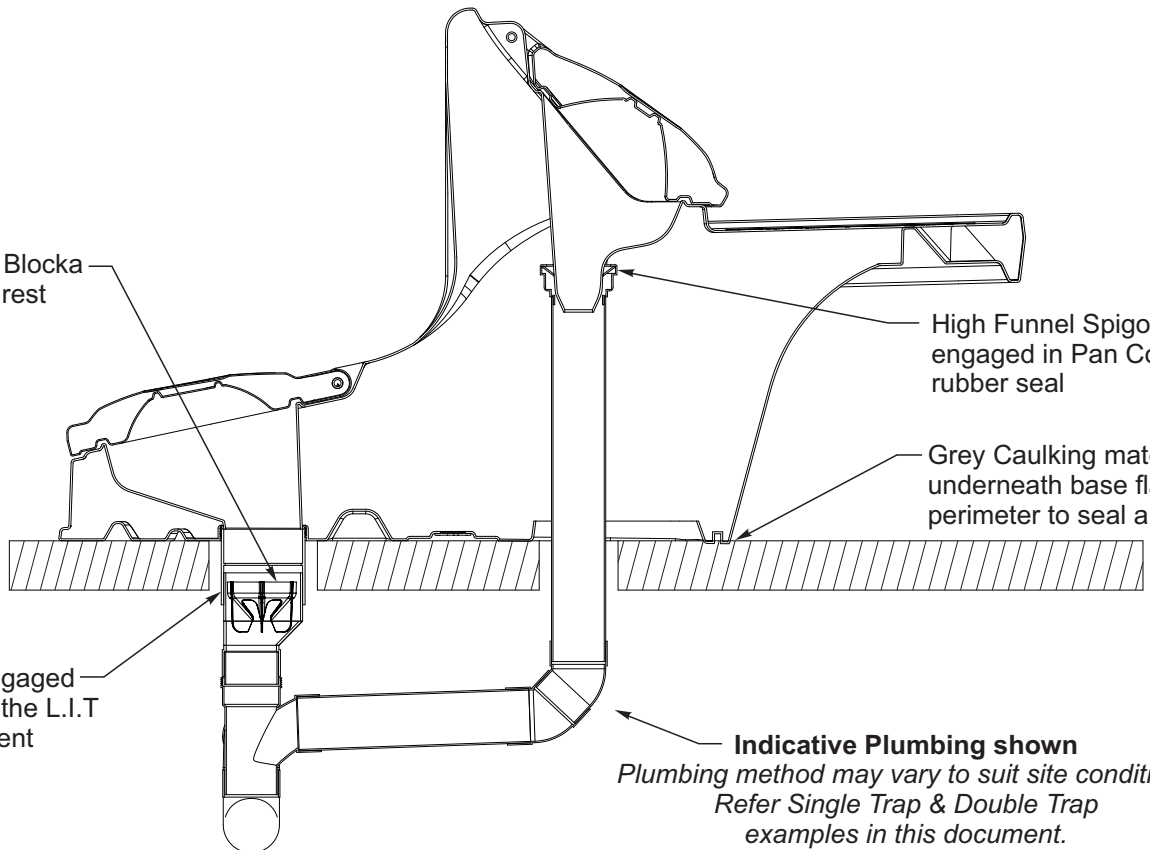

Fixing Down

Fix the unit into position using Stainless steel Fasteners.

Clean up any excess caulking material

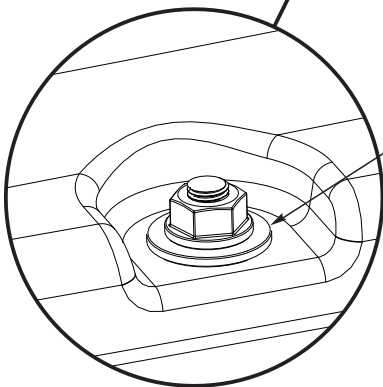
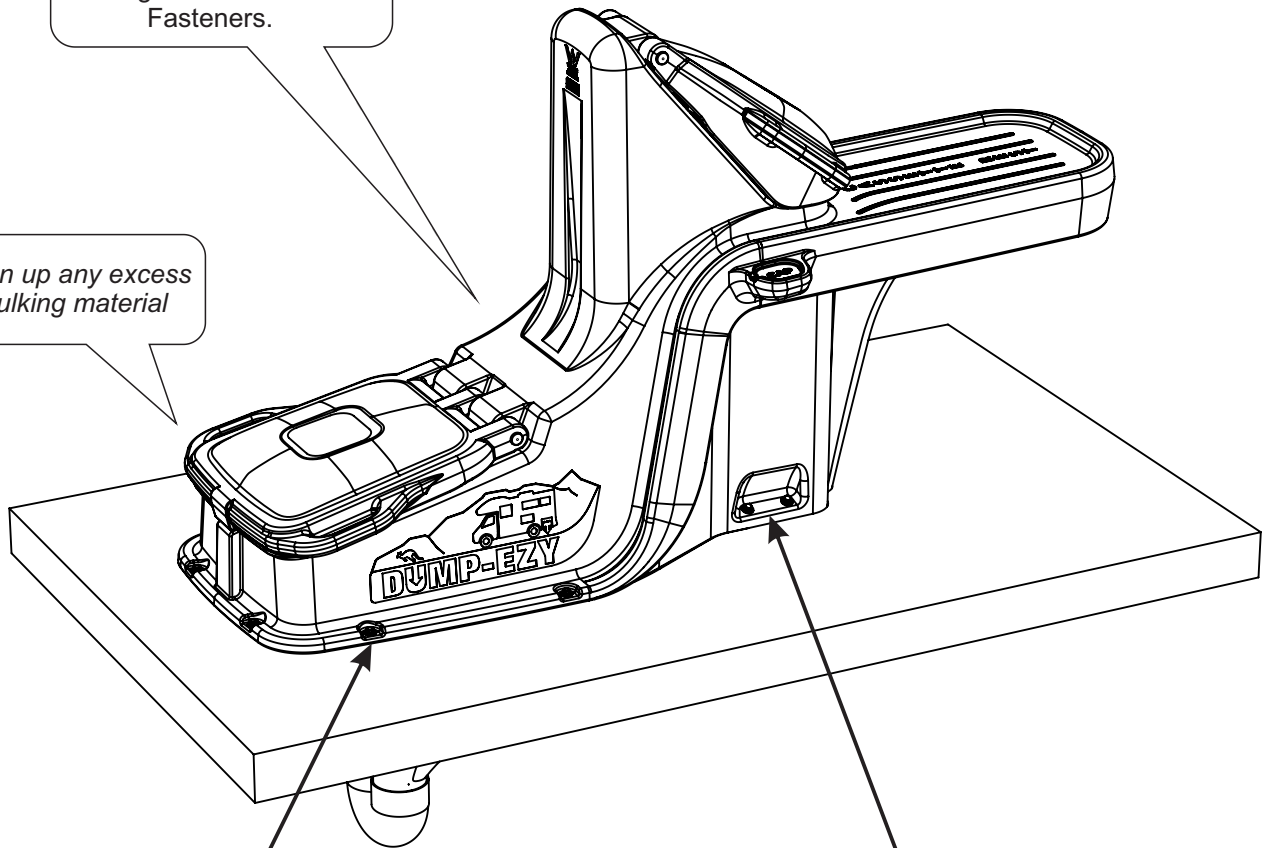

M10 SS Washers

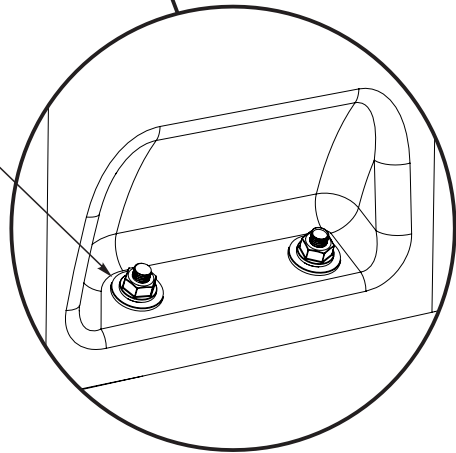

10mm x 75 Hex Nut Dynabolts - Stainless Steel
e.g Ramset™ #DP10075SS
Qty: 6

10mm x 100 Hex Nut Dynabolts - Stainless Steel
e.g Ramset™ #DP10100SS
Qty: 4

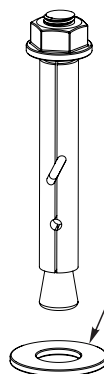

Use M10 Stainless Washer (24mm approx dia.) with Fasteners

Usage Instructions

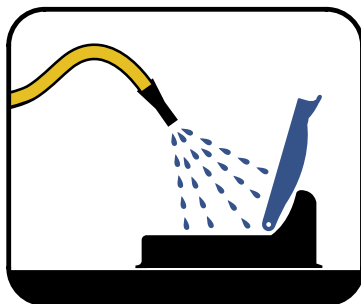

Wash Down

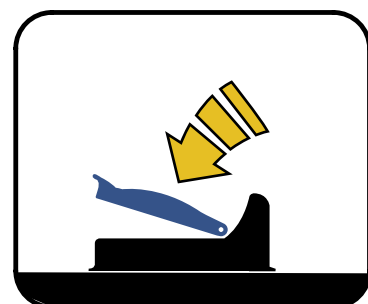

Close the Lids

Maintenance & Cleaning

Construction

The unit is rotationally moulded from tough UV stabilised, non-corroding polyethylene.

Maintenance and Cleaning

The use of harsh abrasive anti-bacterial toilet cleaners is not recommended.

The Dump-Ezy Dump Station can be an entry point for a waste treatment system, which is a living biological process.

Anti-bacterial and strong chemical cleaners have the potential to kill or severely reduce the effectiveness of the living treatment system if poured into the unit.

The surface of the Dump-Ezy unit should only be cleaned with no-abrasive cleaning products as follows.

Cleaning Method

The Dump-Ezy should be cleaned at least twice weekly with a soft brush and a Septic safe cleaning product.

We recommend using a product called EMC by VRM which is available from Tradelink Plumbing supplies.

Mix EMC in the ration of 1:10 into half a bucket of water. Scrub all over the Dump-ezy surface with a soft brush to remove all soiling. If required use the concentrated EMC to remove stubborn soiling.

Wash down the outside fo the Dump-Ezy with the same product.

Any remaining mixed cleaning product may be tipped down the waste. Hose down the general area.

Sludge Management

If you Dump-Ezy is connected to a septic tank, you will need to monitor the sludge level in the tank.

A sludge gauge can be used to determine when the disposal is required and a regular interval can be established if usage is reasonably regular.

Questions

Please contact Gough Plastics on Free call 1800 069 805 (International +61 7 4758 6400 or your local Agent.

Website - www.gough.com.au/dump-ezy/default.htm